



SAFETY. SINCE 1898.™

# ADP20

## Air-Driven Free-Air® Pump

The convenient air-driven ADP20 Free-Air pump is an ideal alternate ambient air source for supplied-air respirator users. The ADP20 Free-Air pump does NOT create Grade D breathing air. The ADP20 is the best choice for users working in locations without an electrical power source (but compressed air is available). Alternatively, the ADP20 is also ideal for potentially explosive work environments that would require a costly, explosion-proof electrical motor.

Expensive carbon monoxide alarms may not be required since the industrial compressor air is not directly used by the worker. The pump inlet filter must be located at a source that will supply a minimum of Grade D breathable air, at all times, which is transferred to the worker through through the air-driven compressor on the ADP 20. Industrial compressed air at a minimum volume of 85 cfm at 95 psig (2400 lpm at 6.6 bar) is used to power the ADP 20 pump.

The powerful ADP20 pump is not only versatile but allows the use of a Bullard personal air cooling device to provide additional worker comfort and productivity. The pump provides 24 cfm of air operating at 5 psig (680 lpm at 0.35 bar). Maximum pressure output is 20 psig (1.4 bar).

Used without a personal air cooling device, the ADP20 pump can supply a continuous flow of air for up to three (3) workers wearing supplied-air full face mask type respirators or up to two (2) workers wearing supplied-air hood or helmet style respirators.

For enhanced worker comfort, the ADP20 can supply air to one worker using the Bullard Frigitron® 2000 Series personal air cooling device in conjunction with a Bullard hood or helmet series respirator. The Frigitron can lower the temperature of the air supplied to the respirator hood by as much as 20°F (11°C) resulting in a more comfortable and productive worker.

**The ADP20 pump does not require CO monitors, alarms or calibration procedures.**

**The Frigitron® 2000 series air cooling device can cool incoming air by as much as 20°F (11°C).**





SAFETY. SINCE 1898.™

# ADP20 Air-Driven Free-Air® Pump

## ADP20 AIR-DRIVEN AMBIENT AIR PUMP SPECIFICATIONS

**AMBIENT AIR FLOW:** 24 cfm at 5 psig  
(680 lpm at 0.35 bar)

PUMP SPECIFICATION TABLE			
Pump Model No.	Maximum Number of Respirators		Maximum Outlet Air Pressure
	Hood	Full/Half	
ADP20	Two	Three	20 psig (1.4 bar)
ADP20 with Frigatron 2000 Series Air Cooling Device	One	None	20 psig (1.4 bar)

The air motor requires a continuous supply of 85 cfm air volume at 95 psig (2400 lpm at 6.6 bar) for optimum performance.

**INLET FILTER:** Medium efficiency, filters out particulates that may be harmful to the pump vanes and rotor clearances.

**OUTLET FILTER:** Carbofine with activated carbon.

**WEIGHT:** 90 lbs. (40.8 kg)

**DIMENSIONS:** 12 3/8" (31.4 cm) Wide x 25" (63.5 cm) Long x 15" (38.1 cm) High (41 1/2" (105.4 cm) High with Air Intake installed)

**NOTE:** Supplied-air respirators used with this ambient air pump must be MSHA/NIOSH approved to operate within the pressure range capability of this ADP 20 pump. Refer to the respirator User Manual for recommended air pressure requirements.

### ORDERING INFORMATION

Cat. No.	Description
23611	Inlet Filter
S17101	Outlet filter cartridge
244852	Outlet filter jar
15922	Pump service kit (Includes four carbon vanes, 23611 inlet filter and S17101 outlet filter cartridge)
17761	Air motor service kit (Includes four carbon vanes, motor bearings, vane springs and seal)
S17931	GAST Safety Solvent, AH255D, aerosol can
S09853	Pressure gauge, motor, 0-200 psig (0-14 bar)
S19683	Pressure gauge, pump, 0-30 psig (0-2 bar)
V22	Quick-disconnect coupler adaptor. Converts pump's quick-disconnect coupler to double 3/8" NPT female connectors
V23	Quick-disconnect coupler adaptor. Converts pump's quick-disconnect coupler to a single 3/8" NPT female connector
V24	Quick-disconnect coupler splitter/adaptor, converts pump's single outlet to a double 1/2" Industrial Interchange coupler (one flowthrough, one shut-off)
V50IN	Remote inlet air hose kit, 50 feet (15.2 m) (one per pump)
V50EX	Remote extension hose kit, 50 feet (15.2 m) (five per pump maximum)

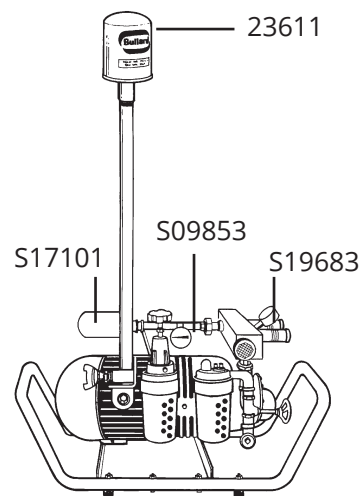

### WARNING

The ADP20 Free-Air® pump DOES NOT filter out carbon monoxide or other harmful or deadly gases. Only climate control devices manufactured by E. D. Bullard Company should be used with Bullard respirators. Using non-Bullard climate control devices can cause death or serious injury or life-threatening delayed lung disease including but not limited to silicosis, pneumoconiosis, or asbestosis. Inlet air filter must be located away from the source of any contaminants and in an area containing at least Grade D breathable, at all times.

E.D. Bullard Company products are manufactured to exacting specifications. Any alteration or modification of these products by the user may adversely affect product performance. This data sheet is in summary form only for easy reference. Refer to labels, instructions, or other literature accompanying the product for complete details regarding use, maintenance, warnings, performance, complete specifications, instructions and precautions.

**Bullard Center**  
2421 Fortune Drive  
Lexington, KY 40509 • USA  
877-BULLARD (285-5273)  
Tel: +1-859-234-6616  
Fax: +1-859-246-0243

**Americas Operations**  
1898 Safety Way  
Cynthiana, KY 41031 • USA  
877-BULLARD (285-5273)  
Tel: +1-859-234-6616  
Fax: +1-859-234-8987

**Bullard GmbH**  
Dieselstrasse 8a  
53424 Remagen • Germany  
Tel: +49-2642 999980  
Fax: +49-2642 9999829

**Bullard Asia-Pacific Pte. Ltd.**  
51 Changi Business Park  
Central 2  
#03-04 The Signature  
Singapore 486066  
Tel: +65 6745 0556

[www.bullard.com](http://www.bullard.com)

Free-Air and The Human Side of Safety are registered trademarks of E. D. Bullard Company. Copyright 1995 by E. D. Bullard Company. All rights reserved including the right of reproduction, in whole or in part, in any form. 8768 (1123)